

Operating and assembly instructions

Congratulation on your purchase of the innovative ONGO®Wing. With the ONGO®Wing, you have acquired the world's first office chair of its kind, which was specially developed for working at a height-adjustable desk and, with its multi-dimensional knowledge, makes something possible that no chair has done before: the stepless transition from normal sitting height to standing height.

Intended use

- **Proper use of the ONGO®Wing.** The ONGO®Wing has been designed for dynamic, healthy sitting. It has not been designed and manufactured for any other purposes. Use the ONGO®Wing only for the intended purpose.
- **Use by one person only.** The ONGO®Wing was designed and manufactured only for the use by one person at any time. If it is being used by several persons simultaneously it might collapse and cause serious injuries.
- **Its maximum load is 110 kg or 243 lbs.**

Height and seat adjustment

Since the ONGO®Wing is designed for use on a height-adjustable desk, you can adjust not only the height but also the seat to your personal needs. There is a flat lever on the left and right in the rear area under the seat.

If you push the left lever up, the gas spring is activated, with which you only influence the seat height;

with the lever pressed up without load and down with load. Pushing the right lever up activates the gas spring that operates the seat adjustments; when the lever is pressed without load, the seat rises and the two wings fold in and with load, the seat lowers to the conventional sitting position with the wings folded out. Of course, intermediate positions are also possible with the seat.

Assembly

Out of respect for the environment the ONGO®Wing will be sent in a size-optimized box. For this the ONGO®Wing has been separated into its three main components (seat with gas spring, arm-/backrest and 5-star base). To assemble remove the protective packaging from the three parts.

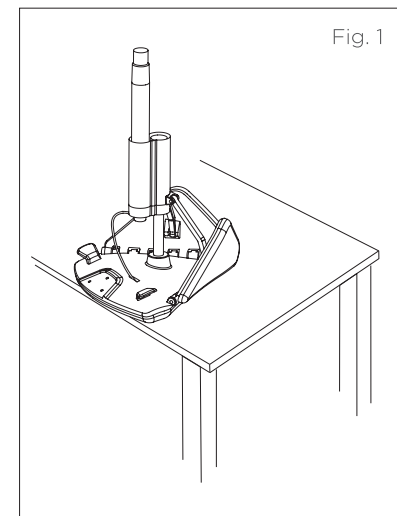

Place the seat and gas strut assembly facing down on a table with the rear portion in direction to you at the edge of the table. (Fig. 1)

ONGO®
agility at work

ONGO® GmbH
Mahdentalstraße 104
71065 Sindelfingen
Germany

T + 49 (0) 7031 410858-0
info@ongo.eu
www.ongo.eu



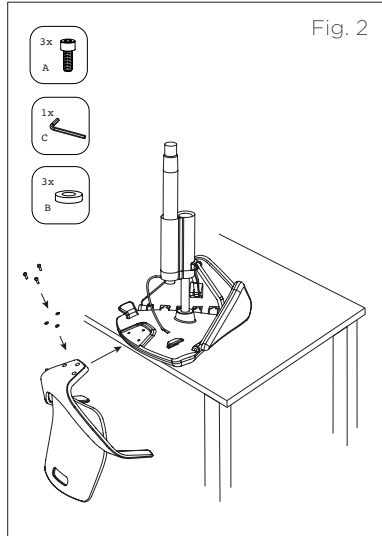

Fig. 2

Then screw the backrest into the slot nuts on the underside of the seat using the three screws (M6 x 18) and Allen key (SW5) provided. (Fig. 2)

Afterwards place the base on the floor and insert the unit consisting of the seat and

backrest with the gas spring into the central cone opening of the base. Sit down on the seat and put weight on it a few times to give the connection a good grip. (Fig. 3)

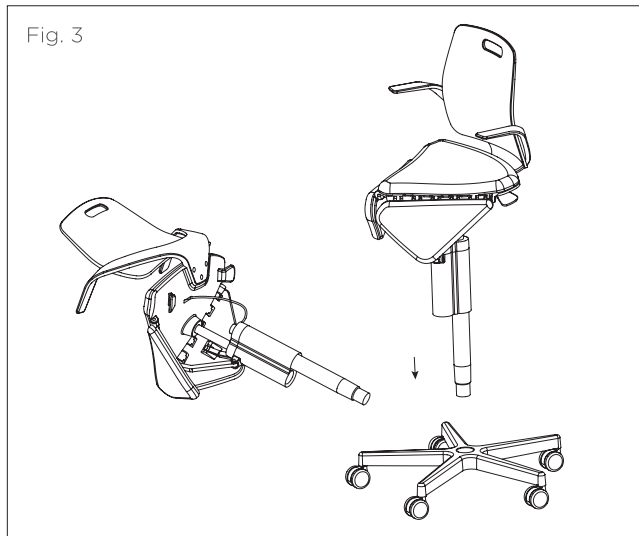

Fig. 3

Care

- Vacuum frequently the fabric Kvadrat Remix. If necessary, clean with lukewarm water and a soft cloth. Please do not use solvents, chloride, abrasive, or chemical cleaning agents. Please note that discoloration caused by jeans or other textiles is excluded from any manufacturer's warranty.
- The plastic parts can be kept clean The plastic parts can be kept clean with mild, diluted household cleaners and a soft cloth. Do not use solvents or abrasive materials.

Recycling

Sustainability and durability are top priorities in all of our design, production, and distribution activities. Short transportation distances reduce environmental impact. The materials of the office chair can be separated relatively easily for recycling. The components either have material labels or can be identified easily using the material list. Dispose of individual materials and components properly according to local recycling and disposal requirements. To avoid unnecessary transportation, the main components of the ONGO®Wing are manufactured by a capable, ISO-certified company, configured with other components (pneumatic height adjuster, cover, etc.) according to the customer's specifications, and shipped directly. ONGO® GmbH accepts discarded office chairs for recycling.

Made in Germany

The design, origin of the materials used, and assembly of our products stand for lasting quality and durability.

Warnings

- **Do not perform mechanical work on the pneumatic height adjuster.** Working on or replacing the pneumatic height adjuster must be performed by trained personnel only.
- **Use of force.** Any misuse and/or application of force on the ONGO®Wing might result in serious physical injuries.
- **Packaging material.** Dispose of any packaging material properly. Keep packaging material out of the reach of children. A risk of suffocation might occur.

Technical specifications

- Hight: 44,5–74,5 cm (17.6 x 29.3 in.)
- Shaft: black / slate grey
- Seat shell and arm rest: black / slate grey
- Seat variable from 50x45 cm (19.68x17.7 in) up to Triangle seat of 12x45 cm (4.72x17.7 in)
- Individually adjustable seat und seat height through 2 gas springs
- 5-star base: Ø71 cm (28 in.)
- Foot castors for hard and soft floors: black

Materialien

- Seat cover: kvadrat - remix, 90 % new wool, 10 % nylon, lightfast, abrasion-resistant
- Seat foam: FCKW-free foamed polypropylene
- Seat shell, backrest, armrest and cover flaps: Polypropylene (Recyclat), glass fibre reinforced
- Gas spring: steel
- 5-star base: plastic, glass-fibre-reinforced
- Double castors: PA, PP
- Double sleeve: polypropylene
- Release lever: polypropylene, glass-fibre-reinforced

- Frame: aluminum
- Seat pad: polypropylene regenerat
- Cone holder: aluminum

Warranty

The ONGO®Wing is a high-quality product. Its over many individual components meet the highest quality requirements. Therefore, we are able to provide a warranty of functionality for the ONGO®Wing for three full years. This warranty is valid for all original parts and starts when the seat is delivered. Please keep your receipt/delivery slip for warranty claims. During the warranty period, ONGO® will provide repair or replacement free of charge after a claim has been submitted and approved by ONGO®. All you need to pay is the costs of transportation. The warranty does not apply to normal wear and tear of parts subject to wear, such as the cover material, defects resulting from improper handling (particularly improper care or damage from knocks, scratches, or rips, use of force) and any modifications made by third parties that are not authorized by ONGO®.